

# CASCADE KENHAR PRODUCT IMPROVEMENT

## Metal Knob Lock Pin Assembly



When **engaged**, knob base is flush with hook



To **disengage**, pull up and turn 180° to rest position

### APPLICATIONS

In a continuing effort to improve products for material handling, Cascade Kenhar developed the metal knob to enhance durability, while maintaining ease of operation.

The new design features easier pin lifting, plus longer, stronger side welds on the upper hook that resist torque from side-loading.

### FEATURES

- Knob secured with stainless steel pin
- Easy to engage, disengage
- Field tested
- Rust and heat resistant

Cascade Kenhar also offers a retro fit assembly to fit metal lock pin kit to existing Kenhar Class 2 and 3 forks.

Mounting Class	Catalog Order No.
2	K2PKR-M
3	K3PKR-M
4	Consult Cascade Kenhar

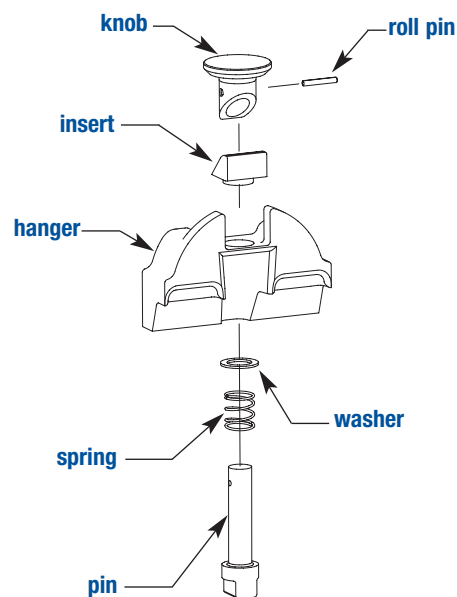

retro fit assembly

East: PO Box 1508 • Guelph, Ontario N1H 6N9 • 877 CASCADE (227.2233) • Fax 519.763.1472

West: PO Box 20187 • Portland, OR 97294-0187 • 800 CASCADE (227.2233) • Fax 503.669.6247 • [www.cascorp.com](http://www.cascorp.com)