



For high-cycle operations requiring a heavy duty paper roll clamp.

APPLICATIONS

Designed for mills, converters, corrugators, stevedoring, printers, warehousing and all applications requiring a rugged, heavy duty paper roll clamp. The 60G is application rated for high-cycle operations handling kraft, linerboard and coated paper stocks. Will handle rolls to 6000 lbs. for 51 and 60 inch diameter and 5000 lbs. for 72 inch diameter.

FEATURES

Optimized Roll Handling

- High grip contact pad surface standard
- Wide variety of contact pad options for all paper types
- Fast 360° rotation
- Great visibility through arms
- Compatible with wide range of damage reduction options

Durability

- Rugged frame and arm construction
- Large diameter pivot pins and bearings
- Compatible with current lift truck hydraulic flow(s) and pressure
- Pinless contact pad mounting
- Heavy-duty rotator gear box and ring gear

Serviceability

- Check valve diagnostic port and check valves can be serviced without clamp disassembly
- Lifting eyes on the baseplate for easy removal and installation of the clamp
- Easy-access hydraulics

MODELS

Fixed frame/fixed short arm

- Good arm profile when handling rolls near maximum diameter

Fixed frame/positioned short arm

- Better long arm profile compared to fixed short arm over wider range of roll diameters

Split arm

- The two long arm sections move independently, allowing you to handle two different size rolls simultaneously
- Patented circuit that provides faster operation



Split arm shown

A rugged, high production roll clamp designed to meet the needs of 3-shift-a-day operations.

60G PAPER ROLL CLAMP

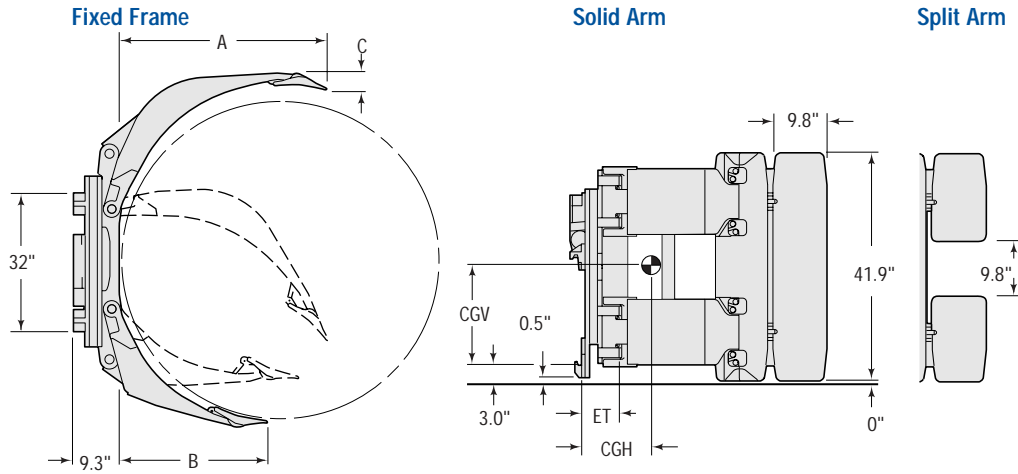

Capacity @ Diameter lbs. @ inches (kg @ mm)	Roll Range	Type	Catalog Order No.	Mounting Class	Mounting Angle ①	Weight lbs. (kg)	Effective Thickness ET	Horizontal Center of Gravity CGH	Vertical Center of Gravity CGV	Long Arm Length A	Short Arm Length B	Long Arm Thickness C
Solid Arm												
6,000 @ 51" (2,700 @ 1295)	20"-51"	Fixed	60G-RCF-A002	II	2°	1,780 (810)	7.3"	10.8"	17.5"	33.0"	23.3"	3.4"
6,000 @ 51" (2,700 @ 1295)	20"-51"	Fixed	60G-RCF-B002	III	2°	1,770 (805)	6.9"	10.5"	17.6"	33.0"	23.3"	3.4"
6,000 @ 51" (2,700 @ 1295)	10"-51"	Positioned	60G-RCP-A001	II	2°	1,810 (820)	7.3"	10.8"	17.5"	33.0"	23.3"	3.4"
6,000 @ 51" (2,700 @ 1295)	10"-51"	Positioned	60G-RCP-B001	III	2°	1,795 (815)	6.9"	10.5"	17.6"	33.0"	23.3"	3.4"
6,000 @ 60" (2,700 @ 1525)	22"-60"	Fixed	60G-RCF-A004	II	2°	1,925 (875)	7.3"	12.1"	17.5"	38.2"	27.2"	2.6"
6,000 @ 60" (2,700 @ 1525)	22"-60"	Fixed	60G-RCF-B004	III	2°	1,915 (870)	6.9"	11.8"	17.6"	38.2"	27.2"	2.6"
6,000 @ 60" (2,700 @ 1525)	10"-60"	Positioned	60G-RCP-A003	II	2°	1,955 (890)	7.3"	12.1"	17.5"	38.2"	27.2"	2.6"
6,000 @ 60" (2,700 @ 1525)	10"-60"	Positioned	60G-RCP-B003	III	2°	1,945 (885)	6.9"	11.8"	17.6"	38.2"	27.2"	2.6"
5,000 @ 72" (2,250 @ 1830)	27"-72"	Fixed	60G-RCF-B006	III	2°	2,120 (960)	6.9"	13.5"	17.7"	44.3"	32.5"	3.6"
5,000 @ 72" (2,250 @ 1830)	15"-72"	Positioned	60G-RCP-B005	III	2°	2,145 (975)	6.9"	13.4"	17.7"	44.3"	32.5"	3.6"

INSTALLATION KIT

Clamp Type	Catalog Order No.
Fixed Frame	212904

HYDRAULIC FLOW

Minimum	Recommended	Maximum	Maximum Pressure
5 GPM	10 GPM	15 GPM	2,600 PSI (180 bar)

HYDRAULIC FUNCTIONS

Model	Hydraulic Functions	Truck Auxiliary Valves Required
Fixed Short Arm	2	2
Positioned Short Arm	2	2

ROTATOR SPECIFICATIONS

Rotator Speed	Rotator Torque
7 RPM @ 15 GPM	70,000 Inch-Lbs. @ 2,600 PSI

DAMAGE REDUCTION OPTIONS

- AFC (Adaptive Force Control)—a computer-controlled clamping system that automatically controls the clamp force in proportion to the load weight (includes Load Cushion™)
- Electronic Rotational Control—for precise 180° and 90° (bilge) positioning, aligning the pad with the roll and reducing costly paper damage

- Tilt Control—automatically controls the angle of the mast and pad, aligning the pad with the roll and eliminating expensive paper damage
- 180° mechanical stop group
- Adjustable bumper—ensures rolls are correctly positioned between the pads, not trapped in the arms
- Load Cushion™—hoist system accumulator that absorbs shocks, reducing the clamp force required to handle a load
- Light Bar Kit and Multi-Setting Relief Valve—light bar shows the pressure setting in use when installed with the relief valve

NOTES

- ▶ Continuous 360° rotation
- ▶ Attachment capacity should be matched to truck rating for most efficient application.
- ▶ Certain types of papers and wrappers present handling difficulties; consult Cascade for assistance in recommending the correct clamp.
- ▶ Split Arm available. Consult Cascade for specifications.
- ▶ Cascade cast pad is standard.
- ① 2° mounting provides a combination of reduced effective thickness, easy bilge handling and improved high stacking capability (up to 268"). 0° mounting must be used when stacking above 268"